

Stalp S2
Vedere laterala
sc. 1:20

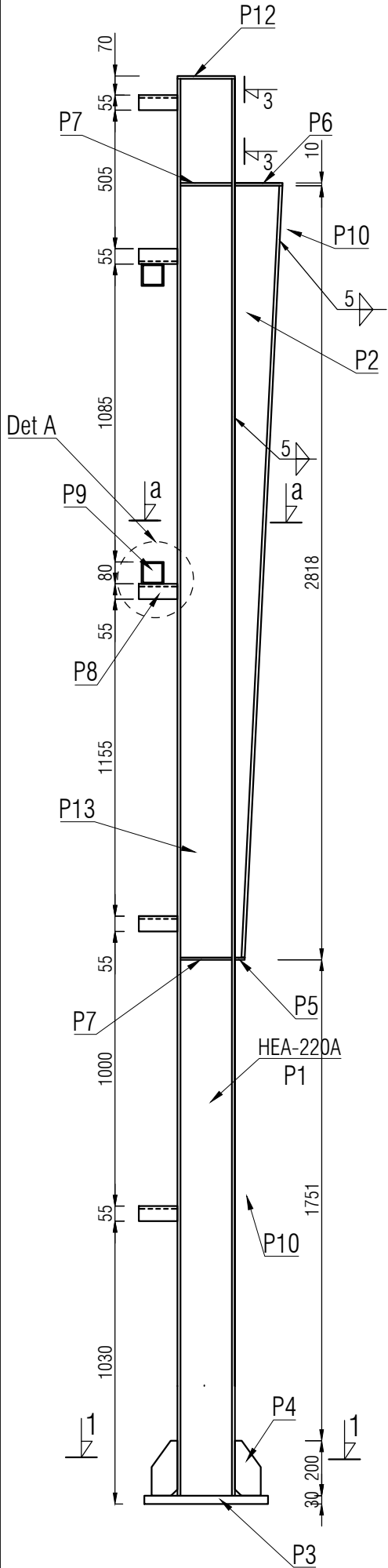

Vedere fata
sc. 1:20

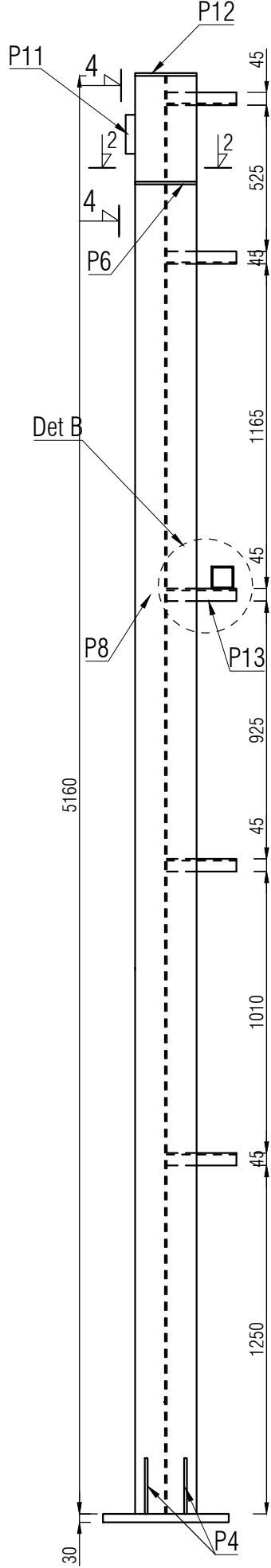

Detaliu taiere vuta
sc. 1:20

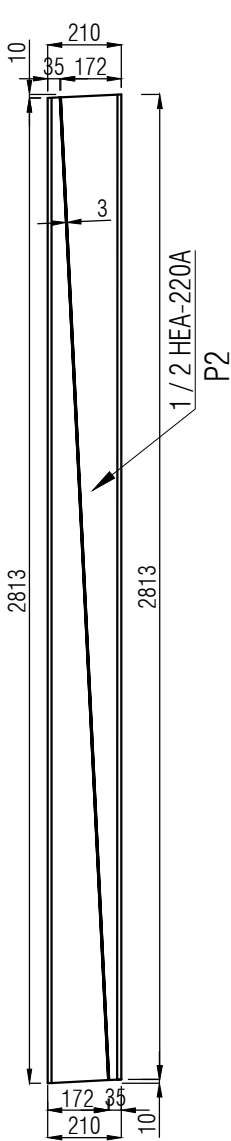

Detaliu taiere P7
Sc. 1:10

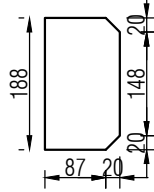

Sectiune 1-1
Sc. 1:10

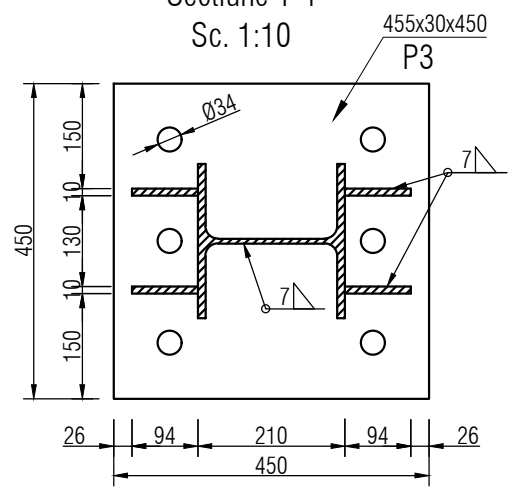

Sectiune 3-3
Sc. 1:10

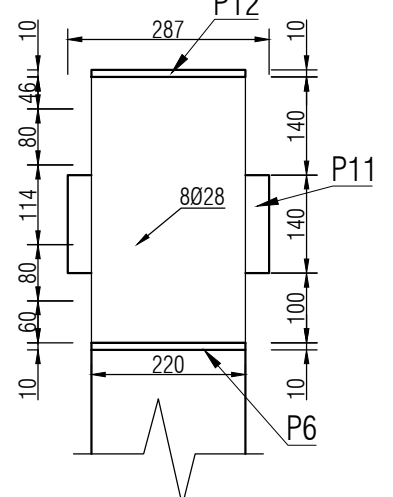

Sectiune 4-4
Sc. 1:10

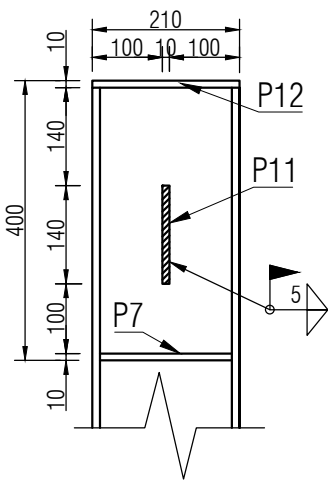

Detaliu taiere P4
Sc. 1:10

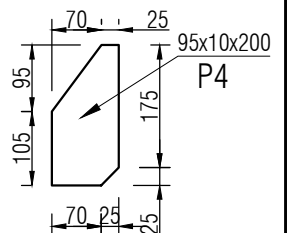

Sc. 1:10

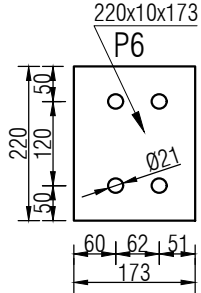

Detaliu taiere P5
Sc. 1:10

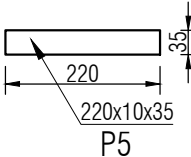

Detaliu taiere P10
Sc. 1:10

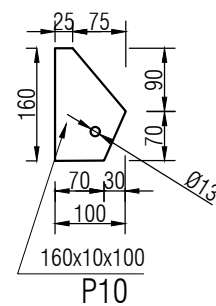

Detaliu taiere P11
Sc. 1:10

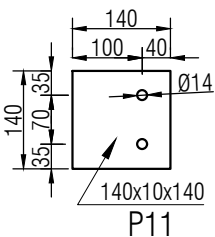

Detaliu taiere P12
Sc. 1:10

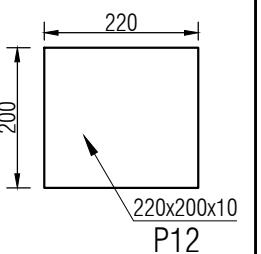

Vedere a-a
Sc. 1:10

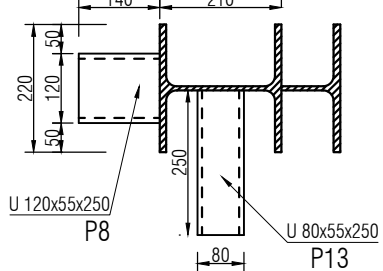

Detaliu A
Sc. 1:10

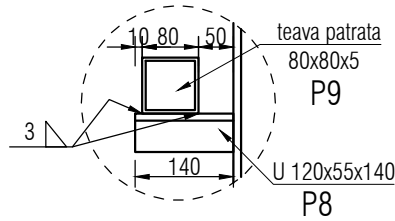

Detaliu B
Sc. 1:10

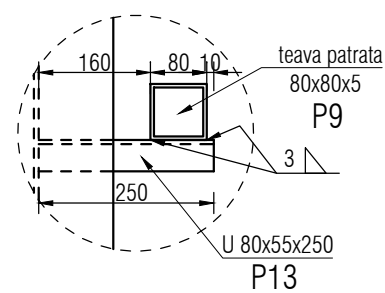

Executia si controlul sudurilor conform SR EN 288-2:1995; SR EN 25817:1993
Protectia anticoroziva conform STAS 10702/2-80
Sudurile se inscriu in nivelul de acceptare defecte, simbol B conf. C150-99 si clasa de sudura II B (pentru sudurile de rezistenta), conf SR 1911-1998
Toate sudurile neindicate se vor executa cu grosimea a=0.5 min pe toata lungimea de contact.
Modificarea solutiilor pe parcursul executiei fara consultarea proiectantului il exonereaza pe acesta de orice raspundere.
La executie si exploatare se vor respecta normele generale si cele speciale de protectia muncii.

Verificator - Nume	Semnatura	Cerinta	Referat / Expertiza Nr. Data
	Ing. Pascu H. <i>Str. Cosminului nr. 7, Timisoara Tel/Fax: 0256 274967</i>		Titlul proiectului: Construire spatii tehnologice adapostire masini speciale mentenanta retele apa-canal str. Cerna, nr.1 Amplasament: Timisoara, str. 1Decembrie, nr. 58 Beneficiar: S.C. AQUATIM S.A.
Sef Proiect	Ing. Pascu H.		Pr. nr. 362/12 P.Th./D.D.E.
Proiectat	Ing. Pascu H.		Sc. 1:50
Desenat	Ing. Padurean C.		STALP S2 08 R